



MOVE

THE SPORTS FAIR
THAT CREATES WELLBEING, GAME
AND LEISURE FOR ALL ABILITIES

APPLICATION FORM



MOVE

THE SPORTS FAIR
CREATING WELLBEING, GAME AND LEISURE
FOR ALL ABILITIES

APPLICATION FORM

MOVECITYSPORT – www.movecitysport.com

WHO	MOVE CITY SPORT Organising Office: email: segreteria@movecitysport.com tel: +39 02 81 500 609 website: www.movecitysport.com
WHAT	MOVE CITY SPORT THE SPORTS FAIR FOR WELLBEING, PLAY AND LEISURE (FOR ALL ABILITIES)
WHERE	BERGAMO FAIR, via Lunga - 24125 BERGAMO
WHEN	TUESDAY 18th and WEDNESDAY 19th OCTOBER 2022 From 9 am to 6.30 pm Setup: from Saturday 15th to Monday 17th October from 8 am to 8 pm Dismantling: Thursday 20th October from 6 pm to 10.30 pm Friday 21st October from 8 am to 2 pm
PRODUCT GROUPS	Available at page 4, 5, 6
ACCESS	Exhibitors will have 3 passes for each exhibition module (16m2), then 1 further pass for each additional module. Exhibitors will receive 2 parking passes for each exhibition module, then 1 further parking pass for each additional module; Parking passes grant parking in the exhibitors parking lot. To activate passes, please visit your profile on our "Web Area" platform.
VISITORS	Free entry for operators, upon invitation or registration at www.movecitysport.com

MOVECITYSPORT – www.movecitysport.com

Promoted by: Organized by:



PROMOBERG



PAYSAGE



Organizing Office: Tel. +39 02 81500609 • www.movecitysport.com • e-mail: segreteria@movecitysport.com

Administrative and Technical Office: **PROMOBERG srl** at **FIERA di BERGAMO** Via Lunga snc 24125 Bergamo • Tel. +39 035 32.30.911

e-mail: info@promoberg.it • e-mail pec: amministrazione@pec.promoberg.it • VAT 01542150162 • SDI Code: SUBM70N

MOVECITYSPORT – www.movecitysport.com

Organizing Office: Tel. +39 02 81500609 • www.movecitysport.com • e-mail: segreteria@movecitysport.com

Administrative and Technical Office: Tel. +39 035 32 30 916 • e-mail: move@promoberg.it

**The COMPANY**

Company Name.....
 Address..... Zip Code.....City.....
 Phone..... Web Site.....
 E-Mail.....Certified E-mail.....
 VAT Number.....
 Contact Person.....Phone Number.....
 Product Group (products and services).....

PARTICIPATION RATE

REGISTRATION FEE (prices do not include VAT)	Quantity	Amount €	Total €
Registration fee includes: electrical consumption, feature of the exhibitor in the online catalogue; cumulative fire and third-party liability insurance policy (theft excluded); electrical system check; setup materials check; fire-fighting and general surveillance; cleaning of shared spaces.	1	300,00	300,00
Products from foreign companies (for the Exhibitor's Catalogue)		10,00	
TYPES OF SPACES (prices do not include VAT)	M2	€/m2	
BARE AREA: (select the preferred option) 16 m2 32 m2 64 m2 m2		140,00	
Set Up PLUS: fireproof honeycombed dividing panels; perimetral band with the exhibitor's name; single-phase switchboard up to 3 kW, electrical multi socket, 1 spotlight every 4m2; carpeting. Furnishing: 1 reception desk, 1 stool, 1 storage closet, 1 coat stand, 1 bin, 1 desk, 3 chairs		70,00	
Set Up SMART: single-phase switchboard up to 3 kW, fireproof honeycombed dividing panels; perimetral band with the exhibitor's name; single-phase switchboard up to 3 kW, electrical multi socket, 1 spotlight every 8m2; carpeting. Furnishing: 1 desk, 2 chairs		50,00	
ADDITIONAL SERVICES (prices do not include VAT)	Quantity	Amount €	
Additional spotlights		40,00	
380 V three-phase power		120,00	
Electrical power - each additional kW		50,00	
Water connection		100,00	
Compressed air connection		150,00	
Furnishing set: 1 table, 3 chairs, 1 reception desk, 1 coat stand, 1 bin		120,00	
TV Screen Rental – 42" screen – art 17		180,00	
Green furniture (vase + plant)		Upon request	
Living (2 armchairs and 1 sofa) – art 05 e 06		480,00	
Desk – Art 02		60,00	
Chair – Art 01		10,00	
Carpeting (m2)		Upon Request	
Storage Closet		100,00	
For additional furnishing see the attached file "MoveCitySport_Allegato Pre-fitted + Furniture"			
Payment Methods: 20% deposit upon signing the contract 80% final payment by 26/09/22 Stamp and Signature _____	Net Amount		
	VAT 22%		
	Gross Amount		
	20% Deposit		

Set Up Plus

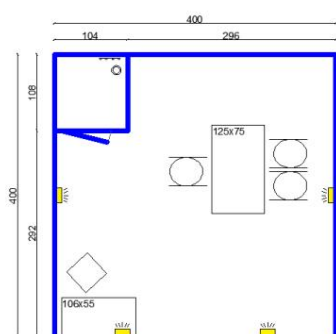

- fireproof honeycombed dividing panels;
- perimetral band with the exhibitor's name;
- switchboard;
- electrical multi socket;
- 1 spotlight every 4m2 ;
- carpeting.

Furnishing:

- 1 reception desk 1
- stool
- 1 storage closet
- 1 coat stand
- 1 bin
- 1 desk
- 3 chairs



Set Up Smart

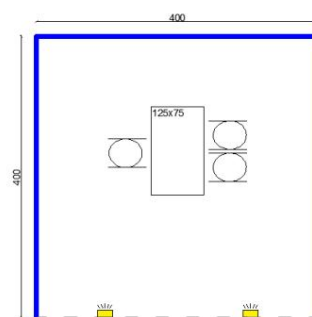

- fireproof honeycombed dividing panels;
- perimetral band with the exhibitor's name;
- switchboard;
- electrical multi socket;
- 1 spotlight each 8m2 ;
- carpeting.

Furnishing:

- 1 desk
- 2 chairs



PRODUCT GROUPS

A01 MULTI-PURPOSE SPORTS FACILITY

- A01.1** FOOTBALL FIELD REALISATION AND REDEVELOPMENT
- A01.2** GOLF COURSE REALISATION AND REDEVELOPMENT
- A01.3** MULTI-PURPOSE SPORTS FACILITY REALISATION AND REDEVELOPMENT
- A01.4** REALISATION AND REDEVELOPMENT OF FACILITIES DEDICATED TO PADEL, TENNIS, VOLLEYBALL, BASKETBALL, BOCCE, AND ALL OTHER SPORTS
- A01.5** SPECIAL FACILITIES REALISATION AND REDEVELOPMENT
- A01.6** GYM REALISATION AND REDEVELOPMENT
- A01.7** INDOOR ARENA REALISATION AND REDEVELOPMENT
- A01.8** PRIVATE/PUBLIC POOLS
- A01.9** STADIUMS
- A01.10** BOWLING ALLEYS
- A01.11** ICE RINKS
- A01.12** SKYDOMES

B02 SUSTAINABLE SPORTS CONSTRUCTION INDUSTRY

- B02.1** ENERGY EFFICIENCY SOLUTIONS **B02.2** CONTINUOUS FACADE
- B02.3** WATERPROOFING
- B02.4** THERMAL INSULATION
- B02.5** BUILDING MATERIALS
- B02.6** BUILDING AUTOMATION
- B02.7** SPORTS FACILITY COMPONENTS
- B02.8** SPORTS FACILITY CONSTRUCTORS

C03 SPORT & GLASS

- C03.1** GLASS WINDOWS AND BALUSTRADES FOR SPORTS FACILITIES

D04 TYPES OF COVERINGS

- D04.1** LAMINATED WOOD
- D04.2** METAL
- D04.3** PRESSOSTATIC
- D04.4** PNEUMATIC
- D04.5** SLIDING
- D04.6** TRANSPARENT
- D04.7** REINFORCED CONCRETE PREFABS
- D04.8** ULTRALIGHT
- D04.9** GEODETIC
- D04.10** TENSILE STRUCTURE
- D04.11** VERTICAL GARDEN
- D04.12** COVERING MAINTAINANCE

E05 SUN PROTECTION

- E05.1** BIOCLIMATIC AND ROLLING PERGOLAS
- E05.2** SUN PROTECTION SYSTEMS
- E05.3** TECHNICAL TEXTILES FOR COVERINGS AND SUN PROTECTIONS

F06 INDOOR & OUTDOOR LIGHTING

- F06.1** STADIUMS AND LARGE FACILITIES
- F06.2** OUTDOOR LIGHTING
- F06.3** SPECIAL EFFECTS LIGHTING
- F06.4** LIGHTPOLES AND LIGHTING TOWERS
- F06.5** OUTDOOR LED SYSTEMS
- F06.6** INDOOR LIGHT ENGINEERING: SYSTEM, APPLIANCES AND PRODUCTS
- F06.7** INDOOR LED SYSTEMS
- F06.8** SOLAR LIGHTING SYSTEM

G07 SUSTAINABLE INDOOR AND OUTDOOR FLOORING

- G07.1** ANTISHOCK FLOOR – RUBBER CASTING OR PRE-SHAPED
- G07.2** SYNTHETIC RESIN FLOOR FOR ATHLETICS AND SPORTS
- G07.3** PERMEABLE PAVING
- G07.4** STABILIZED SOIL
- G07.5** GRANULATED FLOORING
- G07.6** WOODEN FLOOR - DECKING - MASSARANDUBA
- G07.7** WPC FLOORING
- G07.8** SINTERED STONE FLOORING
- G07.9** NATURAL STONE FLOORING
- G07.10** CERAMIC FLOORING
- G07.11** GRES PORCELAIN FLOORING
- G07.12** BICYCLE PATHS FLOORING
- G07.13** PHOTOLUMINESCENT FLOORING
- G07.14** PHOTOCATALITIC FLOORING
- G07.15** ARTIFICIAL SKI SLOPES
- G07.16** SPORTS FLOORING FOUNDATION
- G07.17** SAND (FOR STABILIZING INLAIS AND FLOORING)
- G07.18** RAISED FLOORING SUPPORTS
- G07.19** WOODEN FLOORING MAINTENANCE
- G07.20** FLOORING MAINTENANCE

H08 SPORT, GREEN AND LANDSCAPE

- H08.1** GREEN AREAS FOR SPORTS LANDSCAPE DESIGN
- H08.2** SPORTS FACILITIES FENCING SYSTEMS, TREES AND PLANTS
- H08.3** SPORTS FACILITIES INDOOR AND OUTDOOR GREEN WALLS
- H08.4** GREEN ROOFS AND ROOF GARDENS
- H08.5** GYMS AND SPAS INTERIOR LANDSCAPE **H08.6** INDOOR AND OUTDOOR HYDROPONICS
- H08.7** PARKS, GARDENS AND GREEN AREAS REALISATION
- H08.8** OUTDOORS AND FURNISHED GARDEN LANDSCAPE REALISATION
- H08.9** GREEN AREAS MAINTENANCE
- H08.10** SIGNAGE AND INFORMATIONAL PANELS
- H08.11** FOUNTAINS, WATER PLAY, REFLECTING POOLS
- H08.12** PARKING SYSTEMS
- H08.13** IRRIGATION AND DRAINAGE SYSTEMS
- H08.14** GREEN MAINTENANCE MACHINERY AND EQUIPMENT
- H08.15** AUTOMATIC MAINTENANCE ROBOTS

PRODUCT GROUPS

H08.16 OPERATORS EQUIPEMENT AND OCCUPATIONAL SAFETY

H08.17 ORNAMENTAL TURFGRASS

I09 SPORTS TURFGRASS

I09.1 NATURAL TURFGRASS

I09.2 HYBRID TURFGRASS

I09.3 ARTIFICIAL TURFGRASS

I09.4 TURFGRASS SUSTAINABLE MANAGEMENT AND MAINTENANCE

I09.5 SUBSTRATUM AND SOIL AMENDMENT

J10 INCLUSIVE PLAYGROUNDS AND RECREATIONAL AREAS

J10.1 PLAYGROUNDS AND THEMED PARK DESIGN

J10.2 PLAYGROUNDS FOR KIDS

J10.3 PARK EXERCISE EQUIPMENT

J10.4 THEMED PLAYGROUNDS

J10.5 WATER PARKS

J10.6 PARCOUR

J10.7 CALISTHENICS

J10.8 DOG AGILITY

K11 OUTDOOR FITNESS AREAS

K11.1 WORKOUT EQUIPMENT FOR CAMPSITES, TOURIST RESORTS AND BEACHES

K11.2 WORKOUT EQUIPMENT FOR URBAN AND SUBURBAN PLAYGROUND OR SPORTS AREAS

K11.3 EQUIPMENT FOR SPORTS AND EXERCISE IN CITIES AND PARKS

K11.4 FITNESS TRAIL

L12 URBAN DESIGN

L12.1 BENCHES AND SEATING SYSTEMS

L12.2 PLANTERS AND VASES

L12.3 BIKE-STOPS AND BIKE RACKS

L12.4 TRASH BINS AND WASTE MANAGEMENT

L12.5 CHARGING STATION

L12.6 CLUB HOUSE

L12.7 POTTING SHEDS, BOATHOUSES

L12.8 OUTDOOR CLOCKS

M13 INDOOR AND OUTDOOR POOLS AND WATER SYSTEMS

M13.1 PUBLIC POOL SYSTEMS

M13.2 COMPONENTS, PRODUCTS, ACCESSORIES

M13.3 BASIN AND POOL CONSTRUCTION

M13.4 PURIFICATION AND CONTROL

M13.5 MOVEABLE FLOOR AND WALLS, WAVE GENERATOR

M13.6 WATERPROOFING

M13.7 HOT TUBS AND HYDRO MASSAGE SYSTEMS

M13.8 UNDERWATER ENGINES

M13.9 POOL CLEANING

M13.10 COATING AND PAVEMENTS

M13.11 SANITISATION, CLEANING AND HYGIENE PRODUCTS AND EQUIPMENT

M13.12 ISOTHERMAL POOL COVERS – AUTOMATIC COVERS

M13.13 POOL COVERS

M14 BIO-LAKES

M14.1 NATURAL POOLS AND BIO-LAKES

N15 WELLNESS SPA

N15.1 INDOOR SAUNAS

N15.2 OUTDOOR SAUNAS

N15.3 VAPORIZATION SYSTEM FOR TURKISH BATHS

N15.4 INDOOR HOT TUBS

N15.5 NEBULIZATION

N15.6 SCENT AND AROMA DIFFUSERS

N15.7 WELLNESS FABRICS

O16 SOUND, ELECTRONIC, SOFTWARE

O16.1 SOUND SYSTEM

O16.2 OF SYSTEM

O16.3 SAFETY SYSTEM

O16.4 AUTOMATION SOFTWARES AND INFORMATIC SYSTEMS FOR SPORTS FACILITY MANAGEMENT

O16.5 SCREENS AND DIGITAL BILLBOARDS

P17 ACOUSTICS AND SOUND ABSORPTION

P17.1 FABRICS FOR SOUND ABSORPTION SYSTEMS

P17.2 SOUND PROOFING

P17.3 ECHO ARCHITECTURE

P17.4 PANELS AND FALSE CEILINGS

Q18 FURNISHING AND EQUIPMENT FOR INDOOR SERVICE AREAS

Q18.1 ACCESSORIES AND CONSUMER PRODUCTS

Q18.2 SHOWER TIMERS, TOKEN VENDING MACHINES ETC

Q18.3 STALLS AND SHOWER CUBICLES

Q18.4 LOCKERS, COATROOMS AND SAFES, BENCHES AND COATRACKS

Q18.5 CHANGING STALLS

Q18.6 INFIRMARY FURNITURE

Q18.7 TICKET OFFICE AND BARRIERS, VISITOR MANAGEMENT, VISITOR COUNTERS, THERMAL SCANNERS

Q18.8 PREFAB CHANGING ROOMS AND RESTROOMS

Q18.9 BARS, DINERS AND RESTAURANTS

Q18.10 SIGNAGE AND BULLETIN BOARDS

Q18.11 OFFICES AND CONFERENCE ROOMS

R19 SPORTS EQUIPMENT

R19.1 ATHLETICS

R19.2 BODY BUILDING - FITNESS, PHYSICAL THERAPY

R19.3 HORSEBACK RIDING

R19.4 GYMNASTICS

R19.5 BALL GAMES

R19.6 MARTIAL ARTS

R19.7 EDUCATIONAL GAMES AND TEACHING MATERIALS

R19.8 GOLF AND MINIATURE GOLF

R19.9 MUSCLE BUILDING AND BOXING

R19.10 SWIMMING AND DIVING

R19.11 MODULAR CLIMBING WALLS

R19.12 ARTIFICIAL SKI SLOPES

R19.13 MODULAR SKATE RAMPS

MOVECITYSPORT – www.movecitysport.com

Organizing Secretariat: Tel. +39 02 81500609 • www.movecitysport.com • e-mail: segreteria@movecitysport.com

Administrative and technical secretariat: **PROMOBERG srl: BERGAMO FAIR** Via Lunga snc 24125 Bergamo • Tel. +39 035 32.30.911 e-mail: info@promoberg.it • e-mail: pec:amministratore@pec.promoberg.it



PRODUCT GROUPS

R19.14 PROTECTIVE WALL PADDINGS
R19.15 SPORT HALL DIVIDING PANELS
R19.16 ARCHERY AND BULLSEYE SHOOTING

S20 SPORT NETS

S20.1 SPORT NETS

T21 SPORT & ENTERTAINMENT

T21.1 WATER PLAY
T21.2 MOBILITY PLAY
T21.3 WATER PARK EQUIPMENT
T21.4 SETTING AND SCENIC DESIGN REALISATION
T21.5 ENTERTAINMENT

U22 PROTECTIVE DEVICES

U22.1 PLAYGROUND PROTECTIONS

V23 HEATING AND AIR CONDITIONING

V23.1 AIR CONDITIONING
V23.2 HOT AIR GENERATOR
V23.3 UPS FOR AIR-SUPPORTED STRUCTURES **V23.4**
 EQUIPMENT AND SYSTEMS
V23.5 BUILDING-INTEGRATED PHOTOVOLTAIC
 SYSTEMS
V23.6 HEATING AND AIR CONDITIONING SYSTEMS
V23.7 BUILDING AUTOMATION, ENVIRONMENTAL AND
 ENERGETIC REQUALIFICATION

W24 STANDS, SEATINGS AND FENCES

W24.1 STANDS
W24.2 BALUSTRADES AND RAILINGS
W24.3 SAFETY RAILINGS
W24.4 METAL OR REINFORCED CONCRETE RAILINGS
W24.5 SAFETY NETS OR SUN LOUVRES
W24.6 STANDS SEATINGS
W24.7 PORTABLE METAL STANDS
W24.8 REINFORCED CONCRETE PREFAB STANDS
W24.9 MOVEABLE AND RETRACTABLE STANDS
W24.10 GRID FENCING

X25 SPORTSWEAR

X25.1 TEAM UNIFORMS
X25.2 TECHNICAL SPORTSWEAR

Y26 SPORTS MEDICINE AND PHYSICAL THERAPY

Y26.1 SPORTS SUPPLEMENTS
Y26.2 DIAGNOSIC MEDICINE PHYSIOTHERAPEUTIC STUDIES
Y26.3 ENERGY DRINKS

Y27 SPORTS SERVICE COMPANY

Y27.1 SPORTS CONSULTANTS

Y28 SPORTS FINANCIAL SYSTEMS

Y28.1 SPORTS FACILITY FINANCING
Y28.2 SPORTS ETHICAL FINANCE
Y28.3 OPERATING LEASE
Y28.4 PUBLIC/PRIVATE PARTNERSHIP
Y28.5 PROJECT FINANCING CONSULTING

Y29 SPORTS CLUB MARKETING AND MANAGEMENT

Y29.1 DIGITAL SOLUTIONS FOR SPORTS CLUB
 MANAGEMENT
Y29.2 SPORTS EVENTS DESIGN AND ORGANISATION

Y30 TECHNICAL DESIGN

Y30.1 PROJECT PLANNING

Y31 TECHNICAL PRESS

Y31.1 PUBLISHING COMPANIES
Y31.2 TECHNICAL PRESS

Z32 TRADE ASSOCIATION

Z33 BODIES AND ORGANISATIONS

TIMELINE

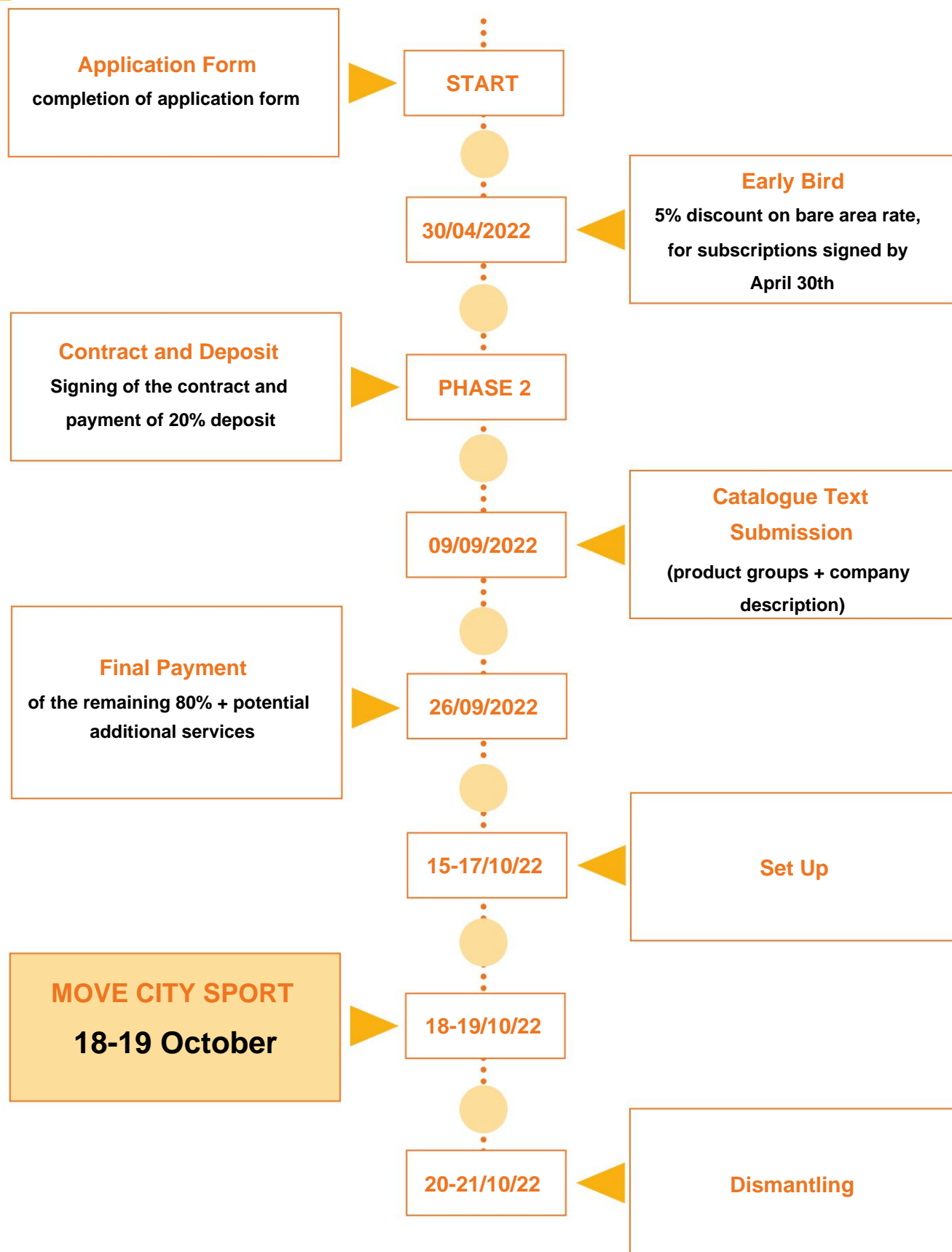

MOVECITYSPORT – www.movecitysport.com

Organizing Office: Tel. +39 02 81500609 • www.movecitysport.com • e-mail: segreteria@movecitysport.com
Administrative and Technical Office: Tel. +39 035 32 30 916 • e-mail: move@promoberg.it